

1 FOUNDATION PLAN
SCALE 1/4"=1'-0"

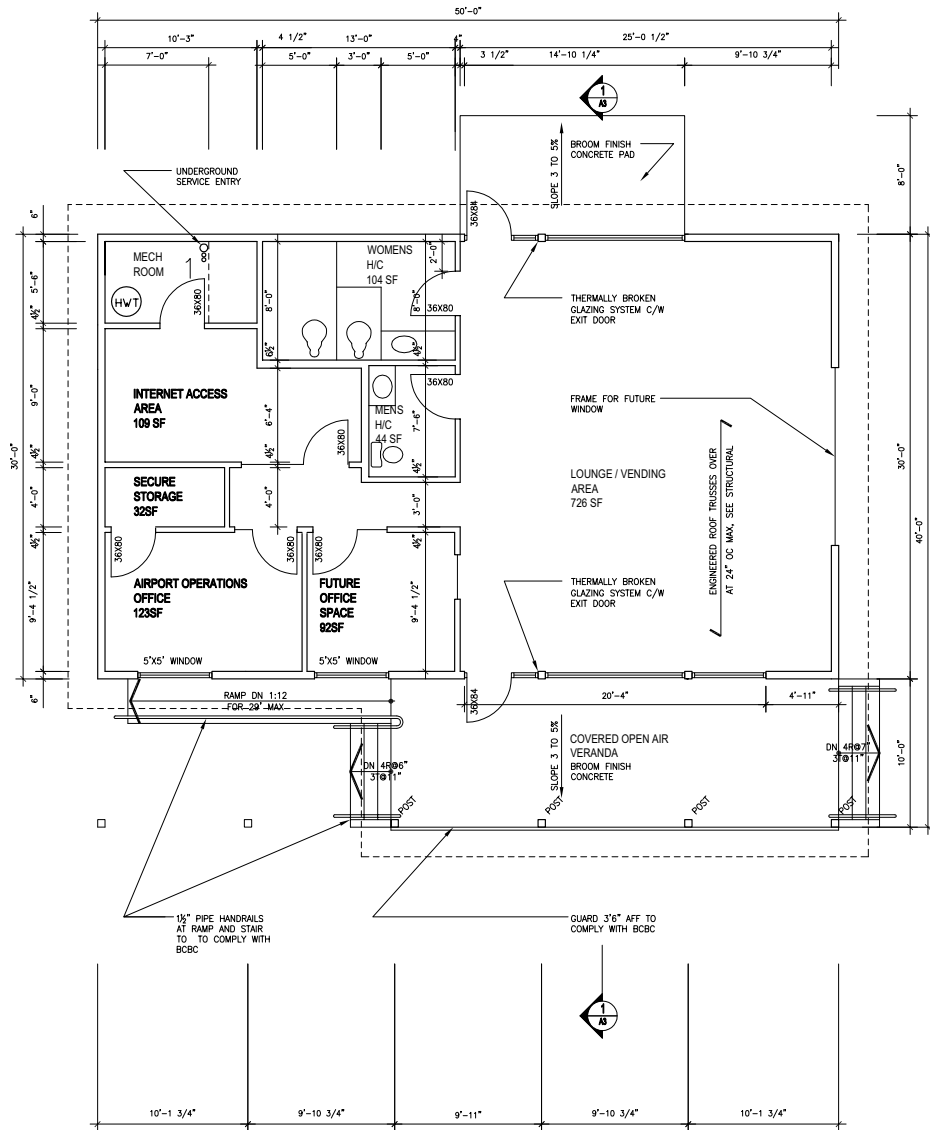

2 FLOOR PLAN
SCALE 1/4"=1'-0"

255 - 45 Durmay Avenue
Vancouver BC V6A 3A3
604.683.1890 phone
604.683.1890 fax
info@carcadden-architect.com

bruce carcadden ARCHITECT inc

PROPOSED TERMINAL BUILDING
PRINCETON MUNICIPAL AIRPORT
FOUNDATION LAYOUT
M GRIGICH CONTRACTING
10-04-07

ISSUED FOR BUILDING PERMIT 9 JANUARY 09

PRINCETON AIRPORT
TERMINAL BUILDING

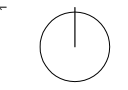

PLANS

MH/BC
BC
08-21
DECEMBER 2008
1/4" = 1'-0"

A2

Copyright reserved. These drawings and the design are, and at all times, remain the exclusive property of the Architects and cannot be used without the consent of the architects.